

MID-CONTINENT ENERGY EXCHANGE

SCHUETTE MINERALS

Comanche and Barber County, Kansas

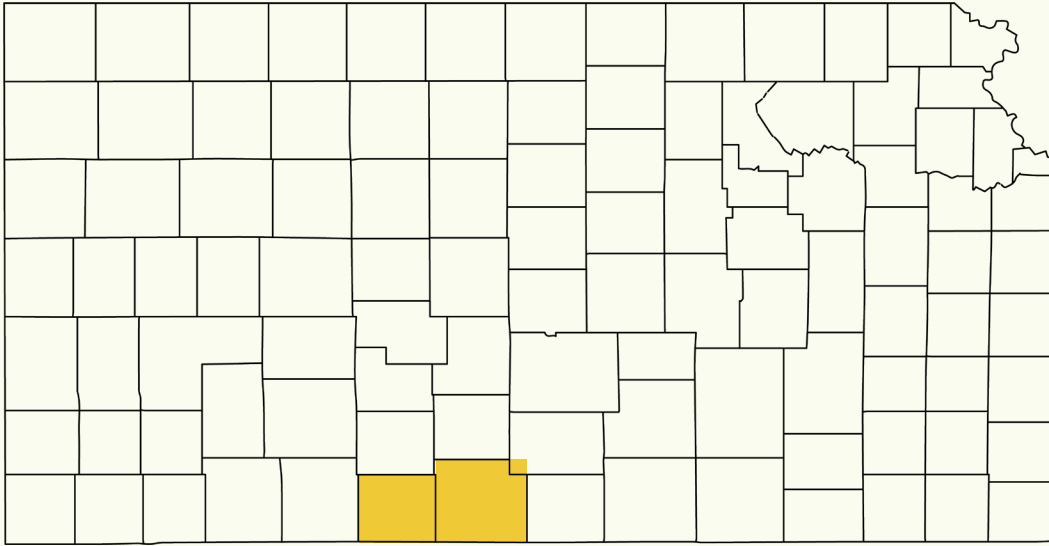

Schuette Family Trust

27 Total Lots

At a glance:

- 7 wells
- 3 producing royalty interests
- 3 overriding royalty interests
- 1 working interest
- 20 non producing mineral lots

Schuette 1-2 - 6111BBL total production between 2013-2017
Schuette #1 - 16258MCF total production between 13-17
Schuette 2 - 31462MCF total production between 13-17
Scheutte 'A' 2 - 24608MCF total production between 13-17
Schuette B/B2 - 10889BBL total production between 84-08
Schuette B/B2 - 5479MCF total production between 13-17
Schuette A/A2 - 2213BBL total production between 13-17
LGK G-26 - 6380BBL total production between 13-17
LGT G-26 - 18722MCF total production between 13-17





MID-CONTINENT ENERGY EXCHANGE

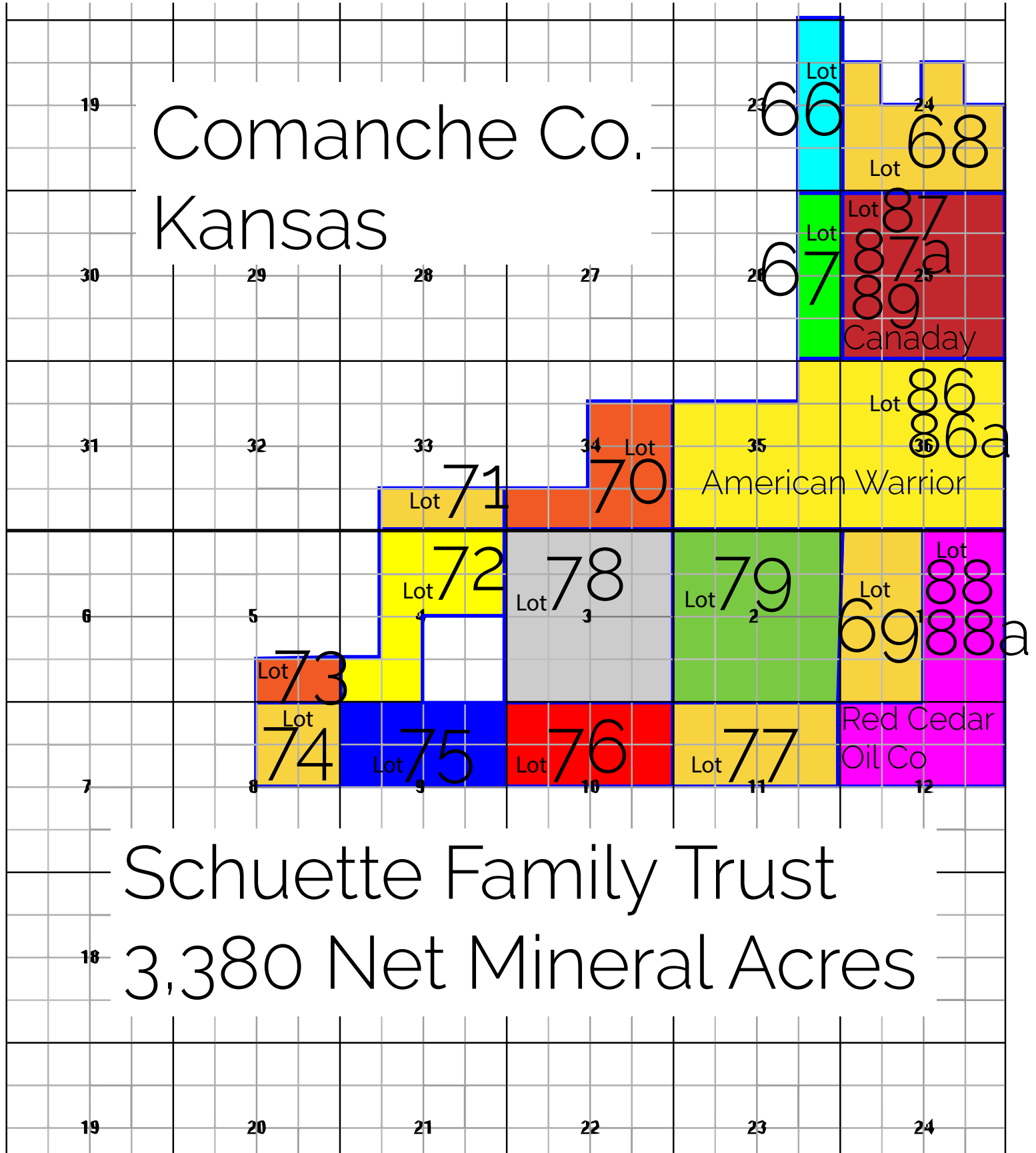

Comanche County, KS Non Producing Acres

Lot Number	Legal Description	Total Acres	Net Acres
66	E/2 E/2 of 23-31s-16w	160	80
67	E/2 E/2 of 26-31s-16w	160	80
68	S/2 & SW/4 NE/4 & SW/4 NW/4 of 24-31s-16w	400	200
69	W/2 of 1-32s-16w	320	160
70	S2 NE/4 & S2 SW/4 & SE/4 33-31s-16w	320	160
71	SE/4 SW/4 & S/2 SE/4 33-31s-16w	120	60
72	NE/4 & E/2 NW/4 & S/2 SW/4 & NE/4 SW/4 of 4-32s-16w	360	180
73	S/2 SE/4 5-32s-16w	80	40
74	NE 8-32s-16w	160	80
75	N/2 9-32s-16w	320	160
76	N/2 10-32s-16w	320	160
77	N/2 11-32s-16w	320	160
78	All 3-32s-16w	640	320
79	All 2-32s-16w	640	320
Total Unleased Acres		4320	2160
Producing Minerals (Royalty Interest) (.0625)			
86	All 36-31s-16w & S/2 & S/2 N/2 & NE/4 NE/4 35-31s-16w	1160	580
87	All 25-31s-16w	640	320
88	E/2 1-32s-16w & N/2 12-32s-16w	640	320
Total Producing Minerals (Royalty Interest)		2440	1220
ORRI (.0234375)			
86a	All 36-31s-16w & S/2 & S/2 N/2 & NE/4 NE/4 35-31s-16w	1160	580
87a	All 25-31s-16w	640	320
88a	E/2 1-32s-16w & N/2 12-32s-16w	640	320
Total ORRI acres (not additional acres)		2440	
Working Interest			
89	All 25-31s-16w	640	
Total Working Interest Acres (not additional acres)		640	



MID-CONTINENT ENERGY EXCHANGE

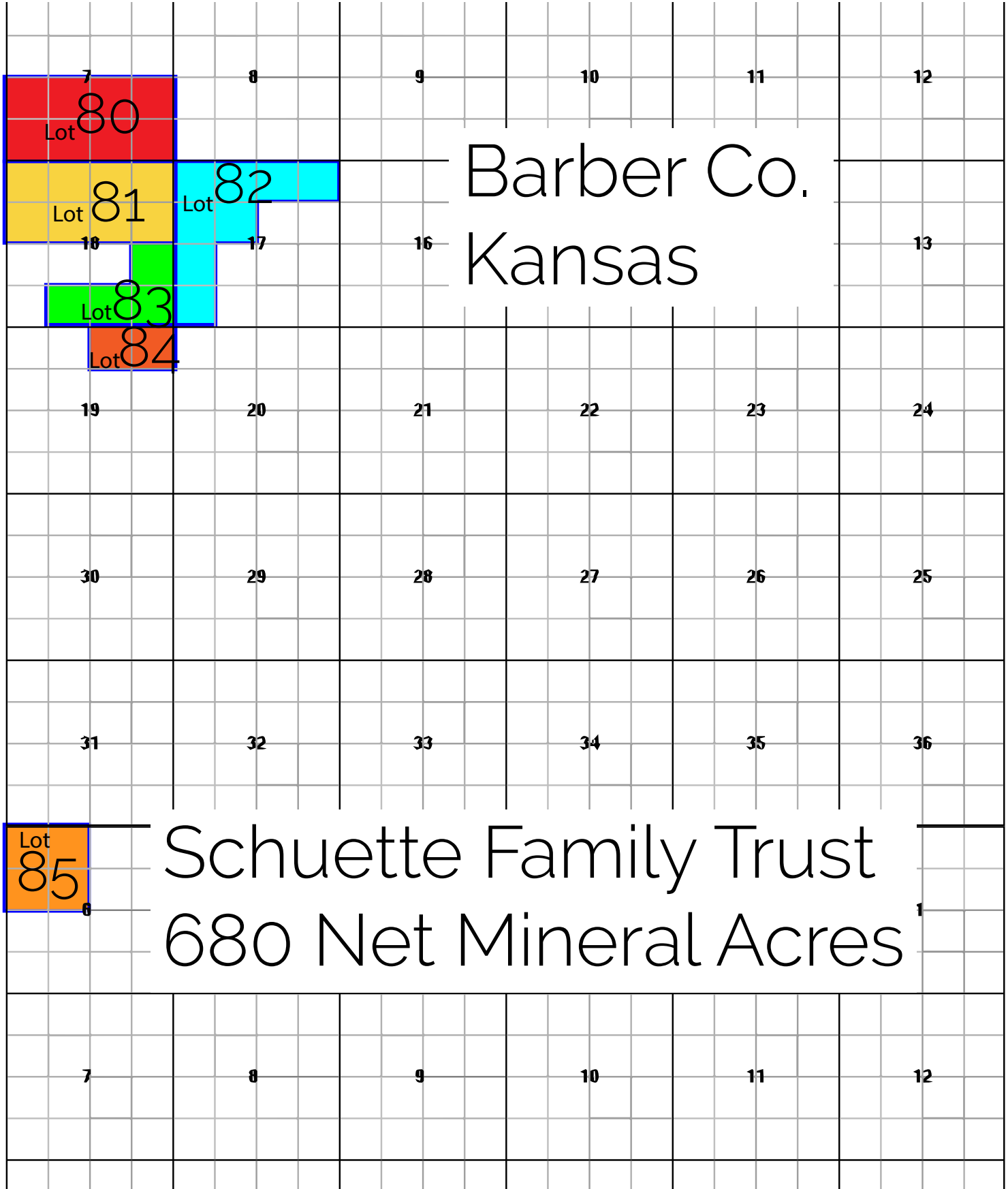

Barber County, KS Non Producing Acres

Lot Number	Legal Description	Total Acres	Net Acres
80	S/2 7-31s-15w	320	160
81	N/2 18-31s-15w	320	160
82	NW/4 & & N/2 NE/5 & W/2 SW/4 17-31s-15w	320	160
83	NE/4 SE/4 & SE/4 SW/4 & S/2 SE/4 18-31s-15w	160	80
84	NW/4 NE/4 & NE/4 NW/4 19-31s-15w	80	40
85	NW/4 6-32s-15w	160	80
Total Unleased Acres		1360	680