

## Lease and Production Information

State	County	Operator			
KS	BARBER	HUMMON CORPORATION			
Location	Meridan	Quarter Call	Formation	Horizontal	Production Months
35-31S-11W	6th (west -96.28)		DOUGLAS GROUP	No	431
			Oil		Gas
<b>First Prod Date</b>			1983-10-01		
<b>Last Sale</b>			2019-08-01		
<b>Daily Rate</b>			4.88		
<b>MoM Change</b>			-11		
<b>YoY Change</b>			-856		
<b>Cumulative</b>			333675		

## Production Snapshot

Month	BOPM	MCFPM
09-2018		
10-2018	306	
11-2018	160	
12-2018	153	
01-2019	310	
02-2019	165	
03-2019	156	
04-2019	302	
05-2019	292	
06-2019		
07-2019	162	
08-2019	151	
<b>Average</b>	<b>216</b>	

## Annual Averages

Year	Avg BOPM	Avg MCFPM
2015	325	
2016	587	
2017	307	
2018	216	
2019	192	



# SMITH 35 120363 - Production Plot

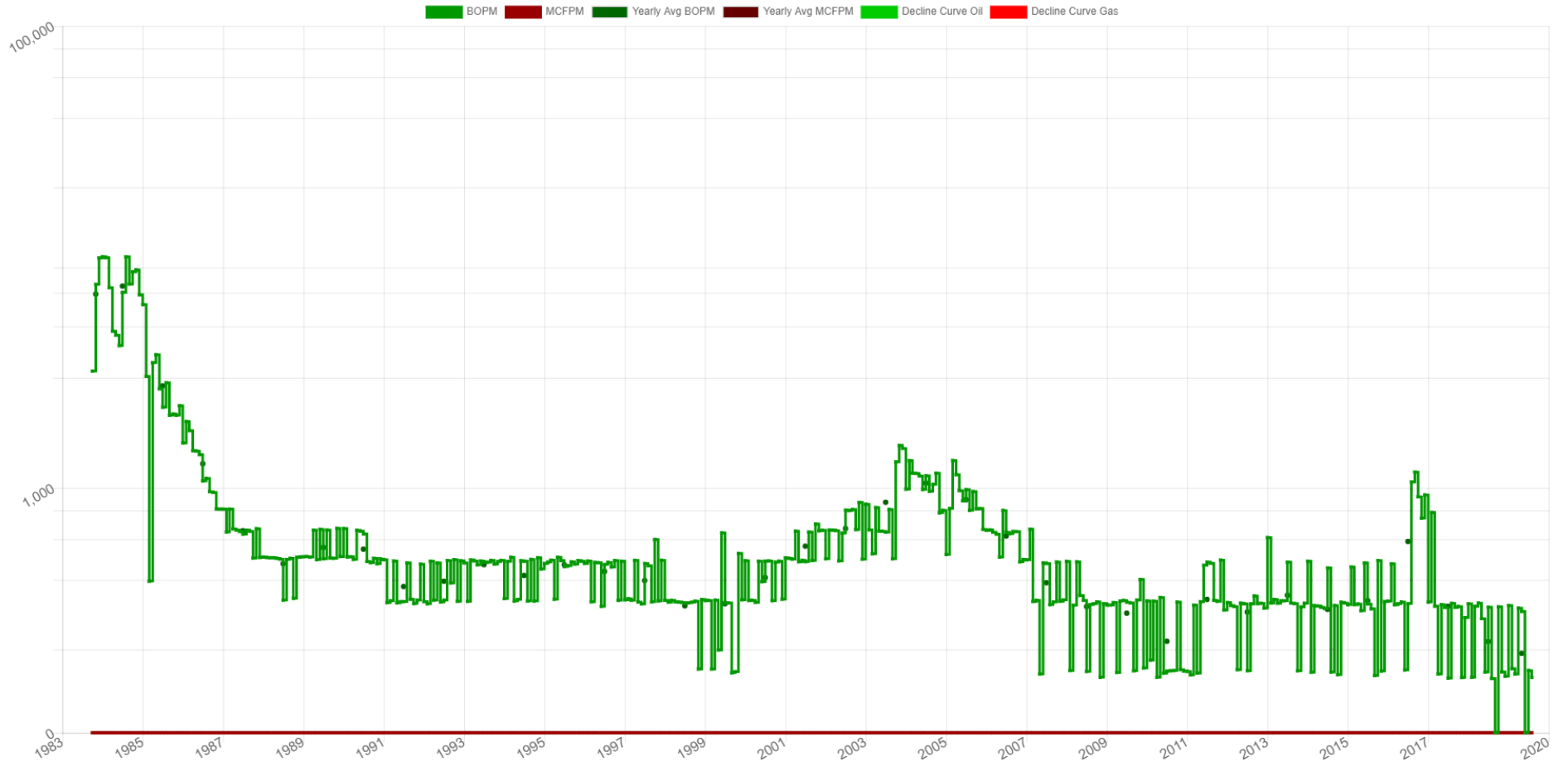



SMITH 35 120363

Associated Wells

Total Well Count: 8

Well Name	API	Operator		Type	Status		
SMITH 1-35	15007216280000	HUMMON CORPORATION		Dry Hole	P&A		
Location	Spot	Foot-NS	Foot-EW	Foot-ref	Zone		
35-31S-11W	SE NE	3300	-660	SE			
Spud	Completion		First Production				
1983-07-05	1983-07-21						
Elevation	MD	TV-TD	Cmpl-Top	Cmpl-Btm	PBTD	Drill-Dir	Lateral
1663 KB		4540					

Well Name	API	Operator		Type	Status		
SMITH 2-35	15007216610000	HUMMON CORPORATION		Oil	Converted to EOR Well		
Location	Spot	Foot-NS	Foot-EW	Foot-ref	Zone		
35-31S-11W	NW SE NE SW	1951	-3145	SE	DOUGLAS		
Spud	Completion		First Production				
1983-09-08	1983-09-14						
Elevation	MD	TV-TD	Cmpl-Top	Cmpl-Btm	PBTD	Drill-Dir	Lateral
1629 KB		3860					

Well Name	API	Operator		Type	Status		
SMITH 2-35	15007216610001	HUMMON CORPORATION		Inj	Authorized Injection Well		
Location	Spot	Foot-NS	Foot-EW	Foot-ref	Zone		
35-31S-11W	NW SE NE SW	1975	-3190	SE			
Spud	Completion		First Production				
2001-12-26	2001-12-26						
Elevation	MD	TV-TD	Cmpl-Top	Cmpl-Btm	PBTD	Drill-Dir	Lateral
1629 KB		3860					

Well Name	API	Operator		Type	Status		
SMITH 3-35	15007216790000	HUMMON CORPORATION		Oil	Producing		
Location	Spot	Foot-NS	Foot-EW	Foot-ref	Zone		
35-31S-11W	SW NE	3300	-1870	SE	DOUGLAS		
Spud	Completion		First Production				
1983-10-06	1983-10-13						
Elevation	MD	TV-TD	Cmpl-Top	Cmpl-Btm	PBTD	Drill-Dir	Lateral
1621 KB		3850					

Well Name	API	Operator			Type	Status	
SMITH 4-35	15007217310000	HUMMON CORPORATION			Dry Hole	P&A	
Location	Spot	Foot-NS	Foot-EW	Foot-ref	Zone		
35-31S-11W	NW NE	4620	-1980	SE			
Spud	Completion	First Production					
1984-01-04	1984-01-11						
Elevation	MD	TV-TD	Cmpl-Top	Cmpl-Btm	PBTD	Drill-Dir	Lateral
1634 KB		3860					

Well Name	API	Operator			Type	Status	
SMITH 5-35	15007218270000	HUMMON CORPORATION			Oil	Producing	
Location	Spot	Foot-NS	Foot-EW	Foot-ref	Zone		
35-31S-11W	E2 SE SW	660	-3200	SE	DOUGLAS		
Spud	Completion	First Production					
1984-06-24	1984-06-30						
Elevation	MD	TV-TD	Cmpl-Top	Cmpl-Btm	PBTD	Drill-Dir	Lateral
1594 KB		3850					

Well Name	API	Operator			Type	Status	
SMITH 6-35	15007218920000	HUMMON CORPORATION			Oil	Producing	
Location	Spot	Foot-NS	Foot-EW	Foot-ref	Zone		
35-31S-11W	NE NE	4620	-660	SE	DOUGLAS		
Spud	Completion	First Production					
1984-08-14	1984-09-12						
Elevation	MD	TV-TD	Cmpl-Top	Cmpl-Btm	PBTD	Drill-Dir	Lateral
1684 KB		3910					

Well Name	API	Operator			Type	Status	
SMITH 7-35	15007219290000	HUMMON CORPORATION			Dry Hole	P&A	
Location	Spot	Foot-NS	Foot-EW	Foot-ref	Zone		
35-31S-11W	E2 SW SW	660	-4515	SE			
Spud	Completion	First Production					
1984-09-24	1984-09-30						
Elevation	MD	TV-TD	Cmpl-Top	Cmpl-Btm	PBTD	Drill-Dir	Lateral
1593 KB		3860					



Layers

Production

Legend

- Oil
- Gas
- O & G

Map Satellite

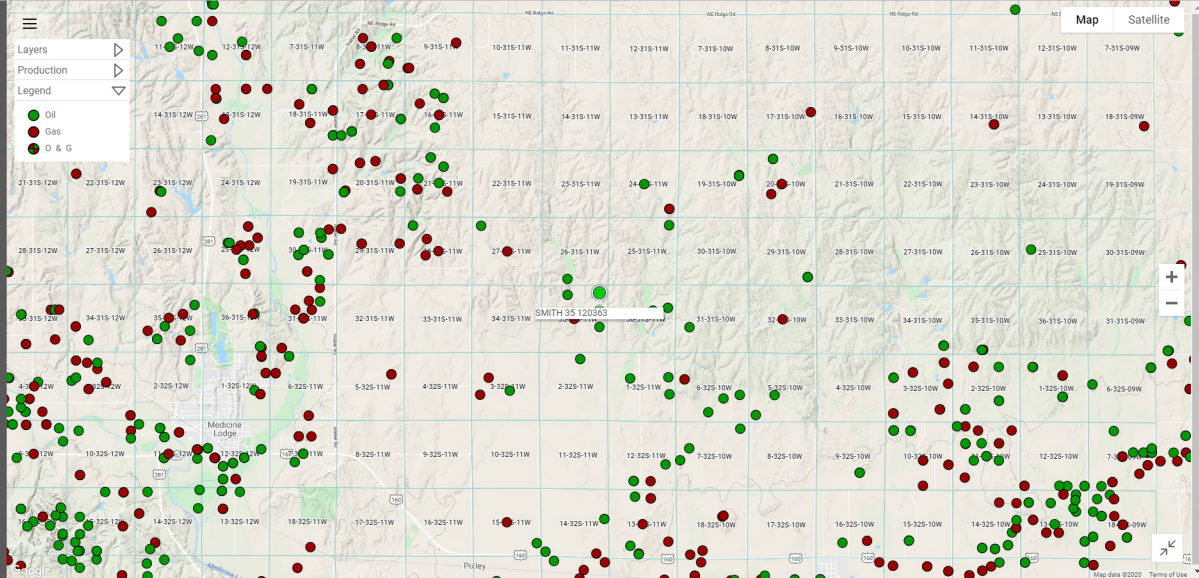

SMITH 35 120363

